



# San Mateo County Navigation Center

The San Mateo County Navigation Center will provide 240 safe, temporary living units and intensive on-site support services to individuals and couples experiencing homelessness. Services will be client-centered and include intensive housing focused case management with the goal of moving people into permanent housing. The Center will also have low entry barriers, increased privacy for clients and space for couples to stay together. People with lived experience with homelessness and many community partners contributed to the development of the site plan. The Navigation Center is a key component of the County plan to offer every unsheltered person who chooses assistance a shelter in an emergency shelter or in temporary or permanent housing.

## Cost and Funding

**\$57 million** total cost

**\$237,500** anticipated price per bed

**\$55.3 million** Homekey Grant Award

California Homekey Grant award that includes \$46.1 million for capital costs and \$9.2 million for operating costs.

**\$5 million** donation by John Sobrato, part of County Match

**\$500,000** federal grant secured by Congresswoman Jackie Speier

**Multiple trade donations** XL Construction, Trade Contractors, and Material Vendors also made contributions and reductions in costs totaling several hundred thousand dollars to support the project and meet the target budget.

**Remaining costs** allocated from County American Rescue Plan Act funding

## Land Swap

**2.5 acres** from Redwood City

On September 28, 2021, the County acquired 2.5 acres at 275 Blomquist St., Redwood City, from Redwood City for rapid development of the Navigation Center. Both the Redwood City Council and the County Board of Supervisors approved unanimously.



Courtyard

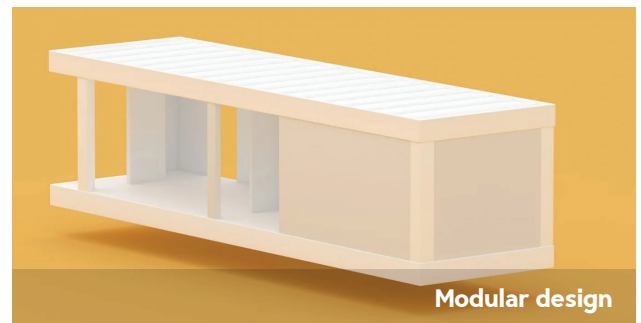

Modular design

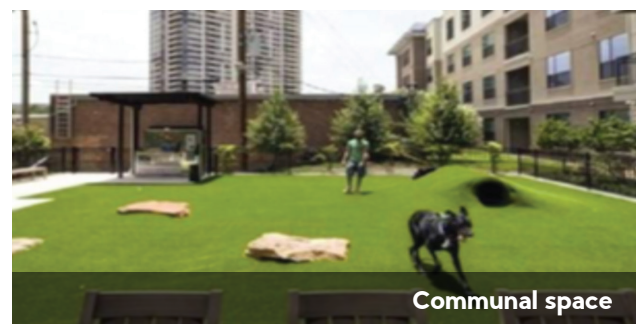

Communal space



Our Year of

**WORKING TOGETHER  
TO END HOMELESSNESS**

[www.smcendinghomelessness.org](http://www.smcendinghomelessness.org)



## San Mateo County Navigation Center Specs



### Site Plan

#### 240 units

168 with in-unit restroom (200 sf)

72 without in-unit restrooms (100 sf)

Array of prefabricated modular units serving around 260 clients at a point in time.

### Site Features

- 68 parking spaces (including 7 electric vehicle spaces)
- Space for 140 bicycles
- All electric commercial kitchen
- Space for on-site support services including case management, health services, and benefits assistance
- Communal space
- BBQ area
- Dog run

### Structures

- North: 3 Stories
- North Middle: 2 Stories
- South Middle: 1 Story
- South: 3 Stories

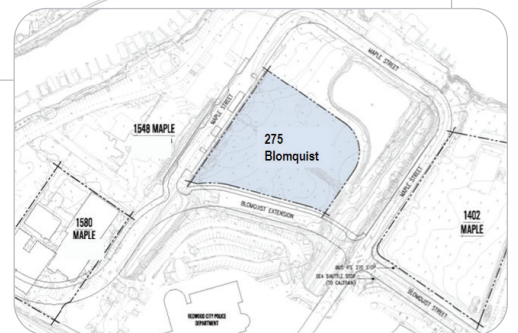

Contractor: XL Construction  
 Architect: Office of Charles Bloszies  
 Trade Partners: Rosendin Electric, EcoFire Sprinklers,  
 Maniglia Landscape, D-Line Constructors



Our Year of

**WORKING TOGETHER  
 TO END HOMELESSNESS**

[www.smcendinghomelessness.org](http://www.smcendinghomelessness.org)